

19/01/2006
VC37

SCHEDULE 12 TO THE DEVELOPMENT PLAN OVERLAY

Shown on the planning scheme map as **DPO12**.

SANDY CREEK ROAD, RIDDELLS CREEK

1.0

19/01/2006
VC37

Conditions and requirements for permits

Any application to subdivide land must be consistent with the approved Sandy Creek Road, Riddells Creek Development Plan included in this schedule.

Drainage work must ensure that the land is suitable for on-site disposal of waste to the satisfaction of the Responsible Authority.

Building envelopes and effluent disposal areas must be marked on the subdivision plans to the satisfaction of the Responsible Authority.

Erosion control measures must be carried out to the satisfaction of the Responsible Authority.

Tree planting of suitable species must be carried out to improve drainage to the satisfaction of the Responsible Authority.

Sandy Creek Road Development Plan

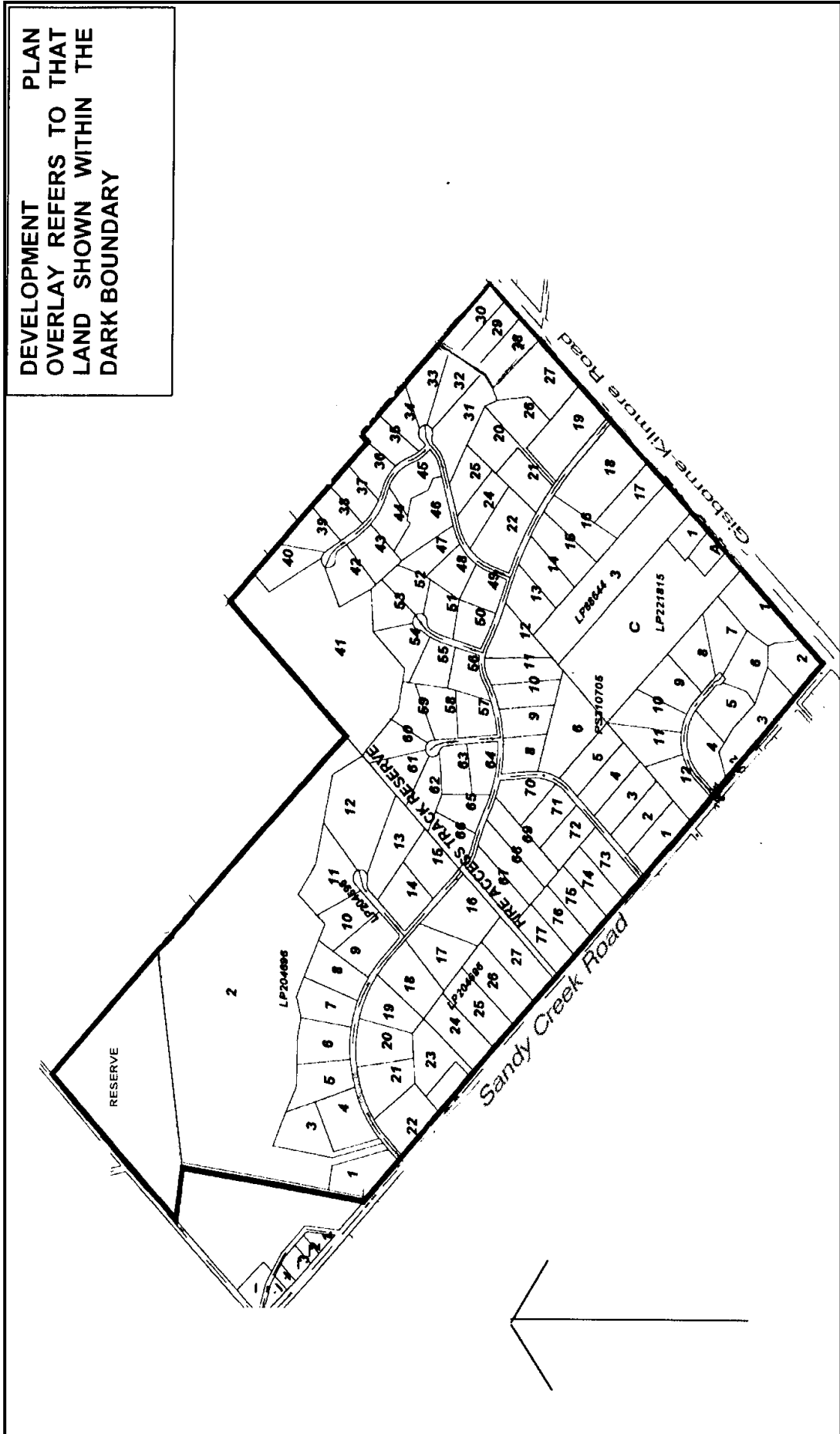

Riddells Creek Development Plan

DEVELOPMENT PLAN OVERLAY REFERS TO THAT LAND SHOWN WITHIN THE DARK BOUNDARY LINE.

MINIMUM CONDITIONS OF DEVELOPMENT

1. Drainage work to ensure suitability of land for on site disposal of waste shall be carried out to the satisfaction of the Responsible Authority.
2. Housing envelopes and effluent disposal areas shall be marked on the subdivision plans to the satisfaction of the Responsible Authority.
3. Erosion control measures shall be carried out to the satisfaction of the Responsible Authority.
4. That tree planting of suitable species be carried out to improve drainage to the satisfaction of the Responsible Authority.

