

25/07/2019
C121sgip**SCHEDULE 1 TO CLAUSE 35.03 RURAL LIVING ZONE**Shown on the planning scheme map as **RLZ**.**1.0**25/07/2019
C121sgip**Subdivision and other requirements**

	Land	Area/Dimensions/Distance
Minimum subdivision area (hectares).	All land except where specified on Map 1 or Map 2.	1 hectare
	All land specified on Map 1 of this schedule.	4 hectares
	All land specified on Map 2 of this schedule	2 hectares
Minimum area for which no permit is required to use land for a dwelling (hectares).	All land except where specified on Map 1 or Map 2.	1 hectare
	All land specified on Map 1.	4 hectares
	All land specified on Map 2.	2 hectares
Maximum floor area for which no permit is required to alter or extend an existing dwelling (square metres).	None specified	None specified
Maximum floor area for which no permit is required to construct an out-building associated with an existing dwelling (square metres).	None specified	None specified
Maximum floor area for which no permit is required to alter or extend an existing building used for agriculture (square metres)	None specified	None specified
Minimum setback from a road (metres).	None specified	None specified
Minimum setback from a boundary (metres).	None specified	None specified
Minimum setback from a dwelling not in the same ownership (metres).	None specified	None specified

Permit requirement for earthworks	Land
Earthworks which change the rate of flow or the discharge point of water across a property boundary.	None specified
Earthworks which increase the discharge of saline groundwater.	None specified

Map 1 and Map 2 to the Schedule to Clause 35.03.

SCHEDULE TO THE RURAL LIVING ZONE

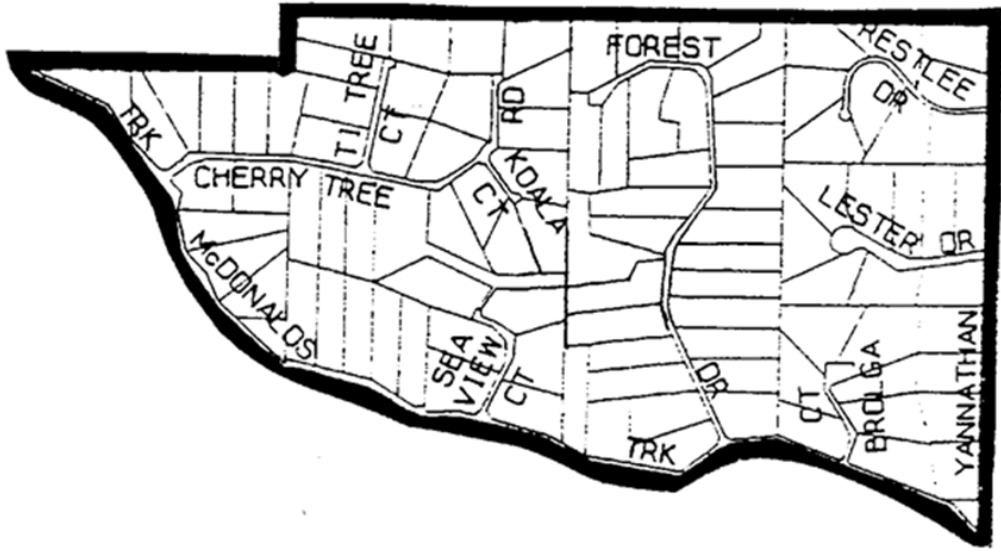

MAP 1

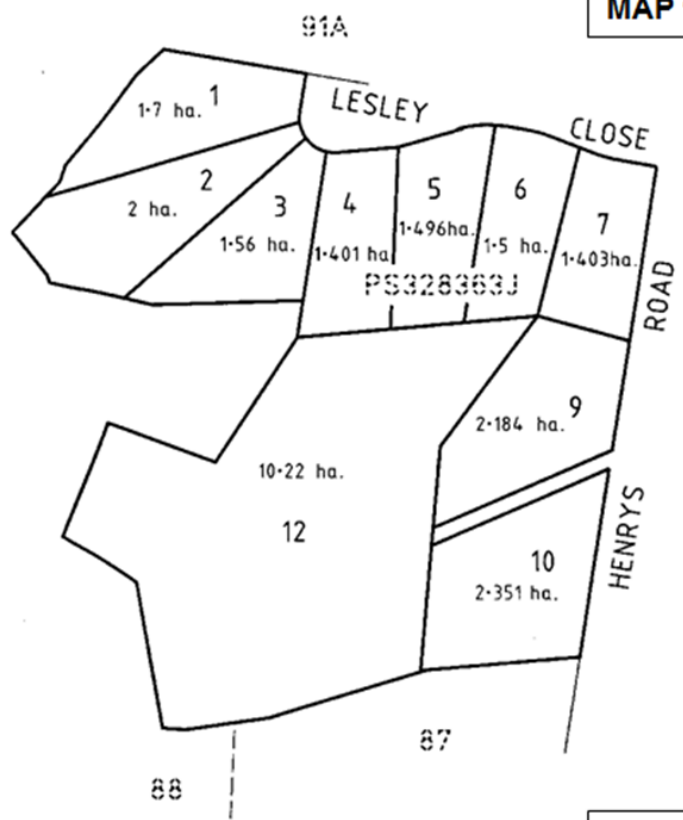

MAP 2